

K-LINE

K-SUPPLY

Power supply for K-Line modules

K-LINE

Accessories



- ▶ Redundant power supply
- ▶ Built-in over-voltage (surge) protection
- ▶ Able to supply up to 75 K-line modules
- ▶ Power supply source to be used for more than one K-Supply module
- ▶ Bridging power supply through the din rail bus connector (K-Bus)
- ▶ Tiny dimensions (102,5 x 93,1 x 6,2 mm)

TECHNICAL DATA

K-SUPPLY – Power supply for K-Line modules

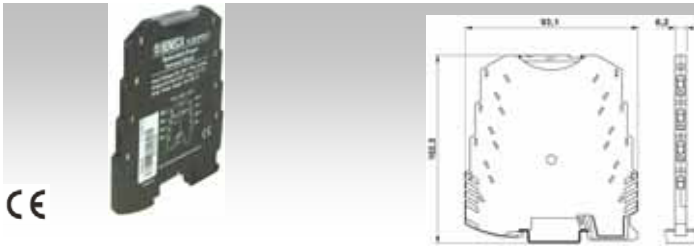

ORDER CODES

K-SUPPLY Power Supply module with surge protection

K-BUS Expandable power supply connector

GENERAL FEATURES

Power supply	19,2...30 Vdc
Power consumption	Max 5 mA per input
Current capacity	- Max 1,6 A with one single input - Max 2 A with in 1 and in 2 connected in parallel
IP Protection	IP 20

Design	Terminal housing for mounting on 35 mm DIN 46277
Dimensions	6,2 x 93,1 x 102,5 mm (w x h x d)
Weight	50 g
Operating temperature	-20...+65 °C
Connections	Plug-in screw clamp terminal blocks, wires up to 2.5 mm ²
Standards	EN50081-2 EN50082-2 EN61010-1 EN60742
Approvals	CE

DIMENSIONS AND INSTALLATION

Inserting / Extracting module on DIN guide

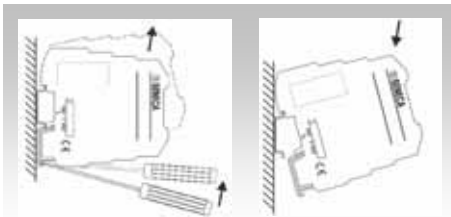

Expandable connector K-BUS

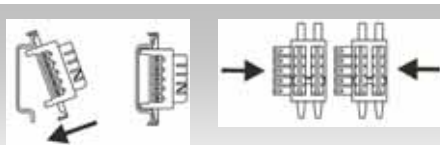

Cage clamp connection

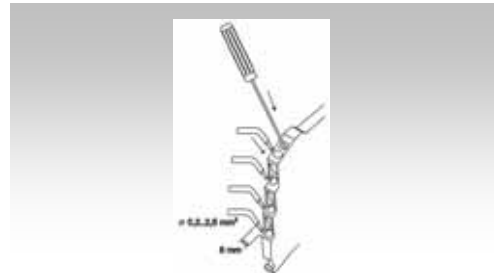

Example of connection with redundant power supply

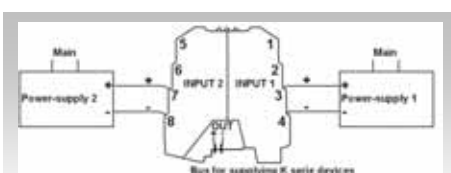

Example of connection to more than one bus

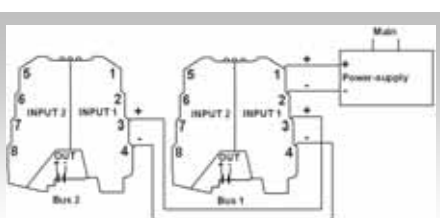

Example of connection with inputs connected in parallel: 2A output

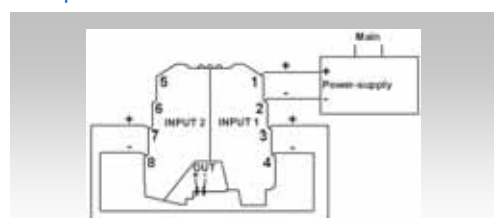

Internal wiring

